

Infinite Adjuster Link System Installation instructions

Inside or Top Mount

1. Mount all of the brackets.

2. Take tube with the Idler or Pin End in it, and place the Infinite adjuster wheel into the opposite end of the tube. The Infinite Adjuster can never be used in the same tube as the clutch (or motor).

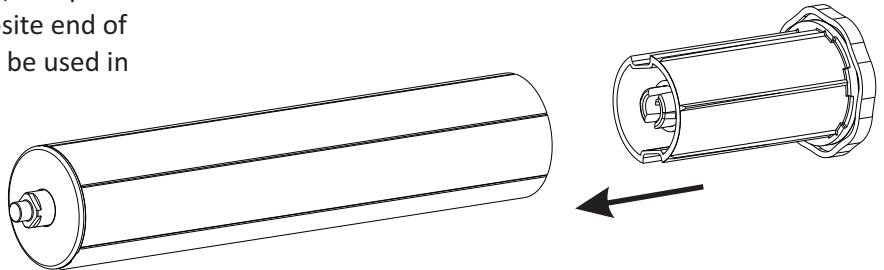

3. Take the tube with the clutch or motor and insert adjuster housing into tube. Then, insert one end of the triangular shaped link through the bearing and then slide the triangular link with bearing into the housing that is in the tube. Make sure the holes on the bearing are vertically lined up or the bearing will not slide into the bracket correctly.

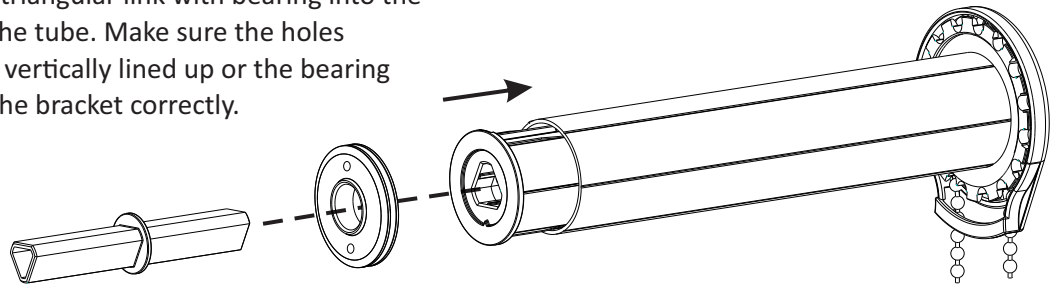

4. Insert the Infinite Adjuster (on the Idler End) onto the triangular shaped link

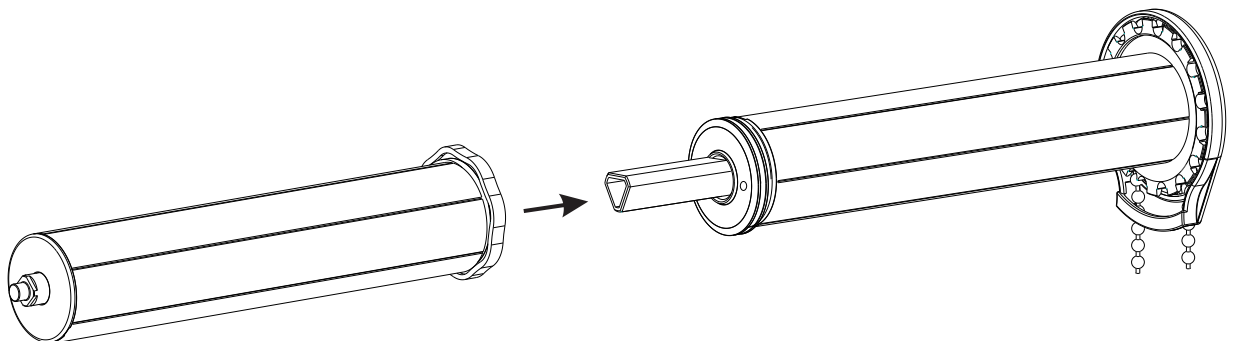

RollEase Headquarters

200 Harvard Avenue
Stamford, CT 06902
Phone: 203-964-1573, 800-552-5100
Order Fax: 203-358-5865

RollEase West

7310 West Roosevelt Street, Ste. 26
Phoenix, AZ 85043
Phone: 623-936-5818
Order Fax: 623-936-5294

www.rollease.com

Infinite Adjuster Link System Installation instructions

Inside or Top Mount

5. All the link shades should be connected and installed together treating them as one unit. While the ends of the shades that are being linked are supported, insert the clutch and pin end into their respective brackets. This will cause the shades to bow down in a “V”-like shape. If the shades are large this will require two installers. The shades require support and should not be left to hang by the clutch and pin end alone.

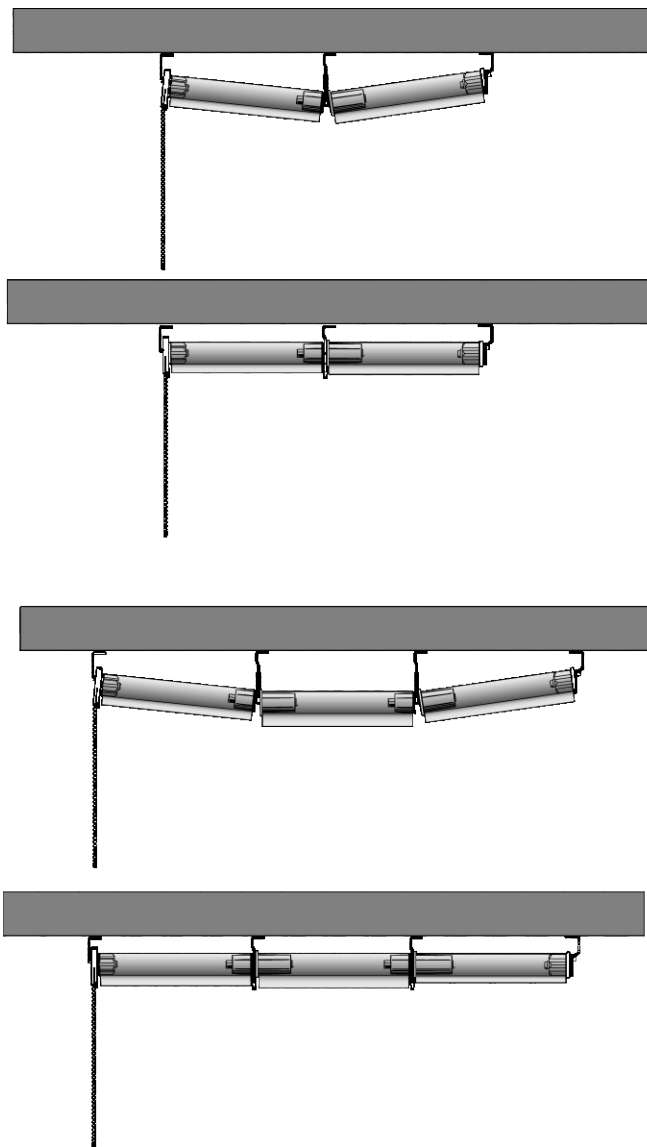

RollEase Headquarters

200 Harvard Avenue
Stamford, CT 06902
Phone: 203-964-1573, 800-552-5100
Order Fax: 203-358-5865

RollEase West

7310 West Roosevelt Street, Ste. 26
Phoenix, AZ 85043
Phone: 623-936-5818
Order Fax: 623-936-5294

www.rollease.com

Infinite Adjuster Link System Installation instructions

Inside or Top Mount

6. Rotate the bearing 90 degrees, and when the one of the holes is lined up on the side, insert your bearing lock and align the lip on the lock with the hole in the bearing, and pop until it locks together. *(Note: The bearing lock is extremely difficult to pull out once it is locked in)*

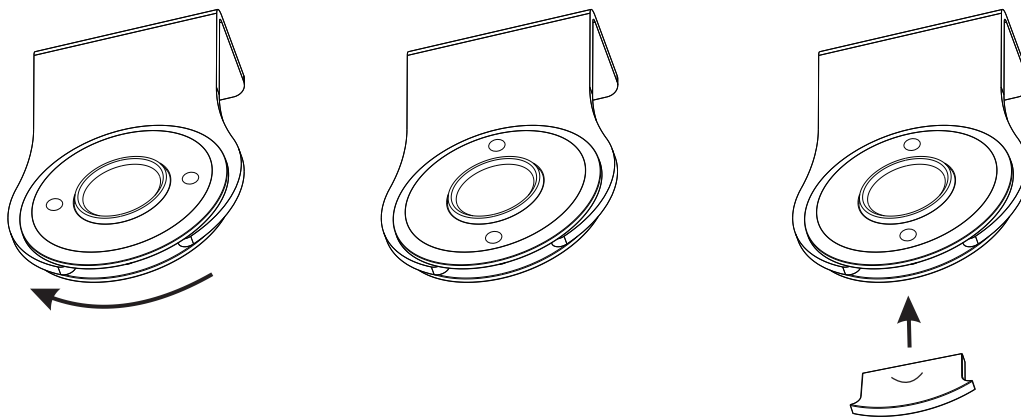

7. Once secured, use the grip wheel on the Infinite Adjuster to adjust the shade on the corresponding tube until it becomes level with the shade on the clutch tube. The level of adjustment is infinitely fine due to RollEase's patented technology.

RollEase Headquarters

200 Harvard Avenue
Stamford, CT 06902
Phone: 203-964-1573, 800-552-5100
Order Fax: 203-358-5865

RollEase West

7310 West Roosevelt Street, Ste. 26
Phoenix, AZ 85043
Phone: 623-936-5818
Order Fax: 623-936-5294

www.rollease.com