

CONTRACT SERIES ONE

Large Open Roller Shade

12v Low Voltage / Solar / Li-Ion Motorized Control



With a myriad of powering options our commercial duty Contract Series One system supports low voltage powering through custom power panels, plug in transformers, solar powered PV arrays or our game changing rechargeable Li-ion internal batter system. The precision engineered Contract Series One motorized open roller shade, is a durable and robust combination of form and function that enables simple, straightforward motorization and installation. Retaining a minimal aesthetic, the motor is hidden and can be constantly charged with a discreet solar PV array, providing the ultimate in energy efficiency, sustainability and privacy. Featuring minimal light gaps, increased privacy, view through and sustainability, setting the benchmark for natural light management.

Features:

- Automate motor Ultra-quiet operation with ARC bi-directional communication.
- Precision engineered, durable construction and modern design
- Enables view through and privacy with minimal light gaps and panel linking options
- Enhance sustainability and efficiency with complete light and thermal control.
- Stylish single or multi-channel motor, wall mounted or handheld controls & smart phone compatibility
- Leveling control; multiple shades finish in the same position for a premium aesthetic.
- Optional solar panel for environmentally forward, energy efficient constant system charging.
- Max width of 120" (based on 120" drop). Capacity to cover areas up to 100 sqf. before linking

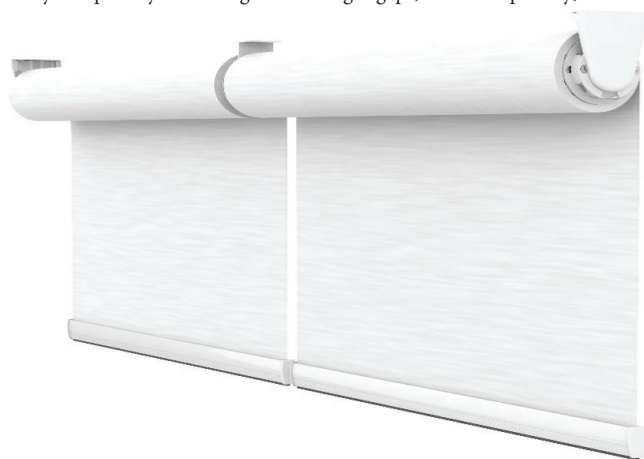

BRACKET COLORS

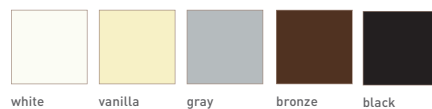

Match this solution with any of our sunscreen, blackout or high performance fabrics for a complete finished solution. See our document library for comprehensive information including HPD, LEED & NRC specifications.

MOTOR OPTIONS

Automate Wall Switches [Hand held or wall mounts]



DC Power Panel [Provides power for 18 DC ARC motors]



Automate Solar Charger [energy efficient]



Automate ARC Repeater [Extends the ARC signal]



ARC Relay Module [Smart System Interface]

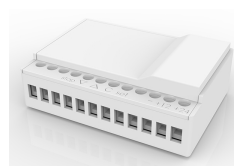

Automate Pulse Hub [Smart Phone Control]



FRONT & SIDE VIEW

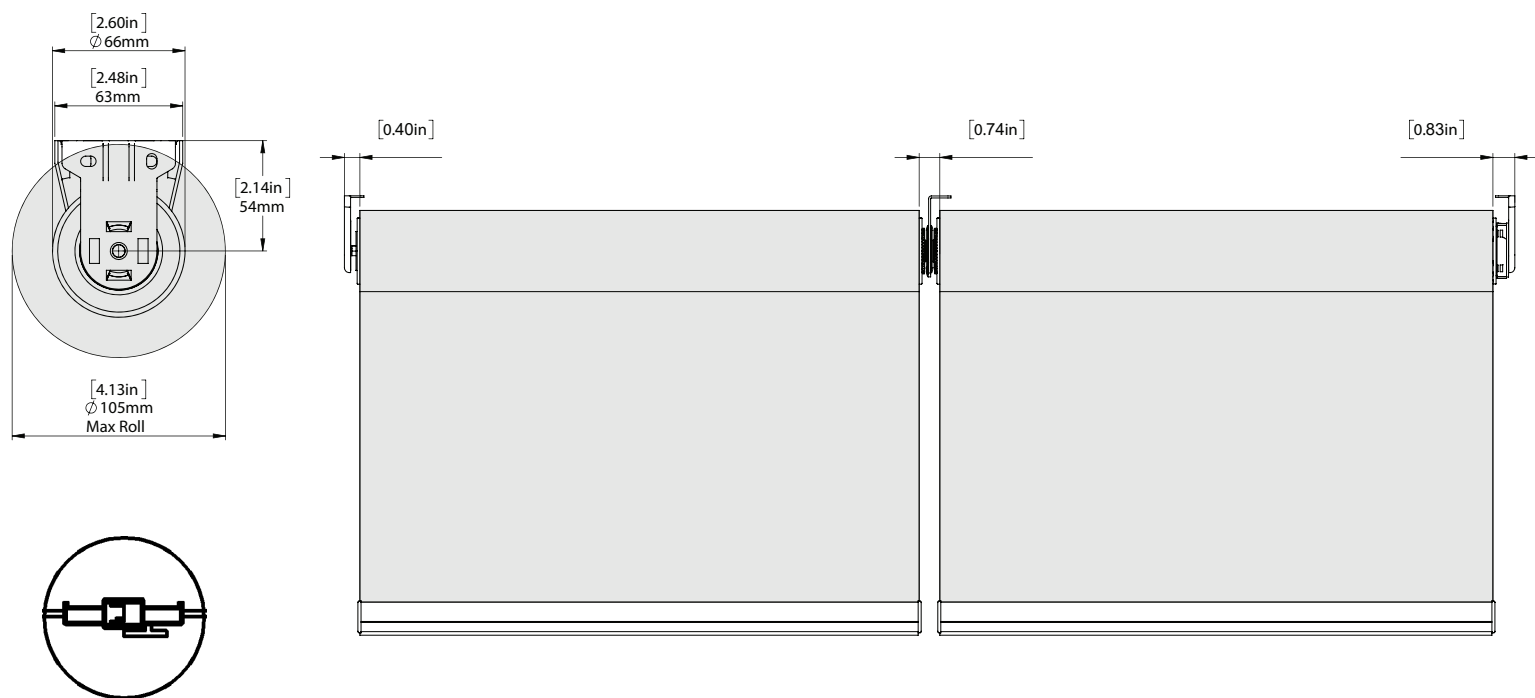

SCHEMATIC

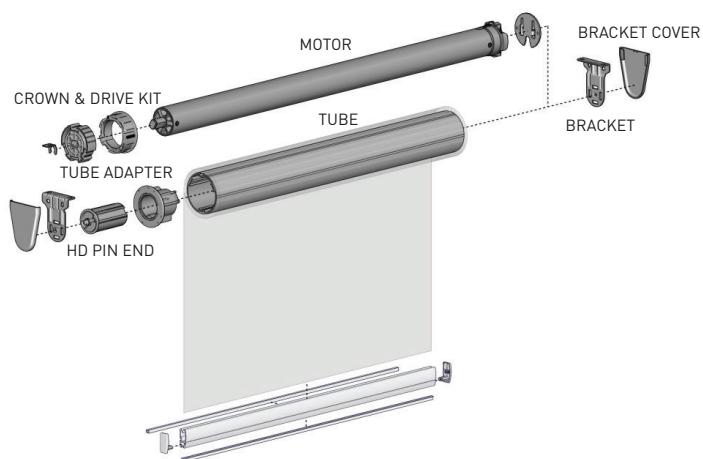

BOTTOM RAIL OPTIONS

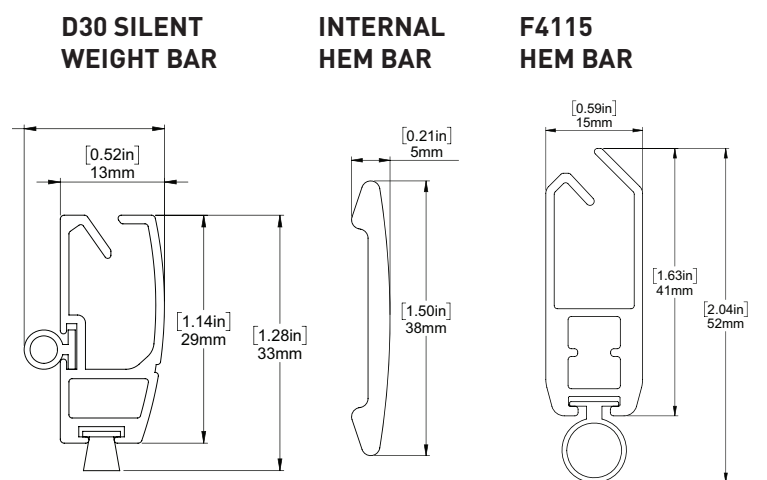

SYSTEM UPGRADES

5" Pocket [for hidden recess mounts]	L & I Clips [for hidden recess mounts]	Edge Side Channels [for improved light blackout]	Internal Wire Guide [supporting complex shading systems]	Fabric Switch System [fast easy changing of fabric on a roller shade]

For more information about our Upgrade solutions, see our UPGRADE SPECIFICATION sheets.