

# CONTRACT SERIES ONE

## Large Open Roller Shade

Line Voltage 120v AC Motorized Control



The precision engineered Contract Series One shading system, integrates a powerful, yet quiet motor, directly in the tubing of the roller which is powered through plug in transformer or hardwired by an EC with connector plug. The precision engineered Contract Series One motorized open roller shade, is a durable and robust combination of form and function that enables simple, straightforward motorization and installation. Retaining a minimal aesthetic, the Automate motorized shade is durably constructed and designed to accentuate the contemporary feel of any space. The Contract Series One system sets the bench mark for performance, design and comfort while providing the ultimate in energy efficiency, sustainability and privacy. Featuring minimal light gaps, increased privacy, view through, and thermal control, setting the benchmark for natural light management.

### Features:

- Automate motor Ultra-quiet operation with ARC bi-directional commu
- Precision engineered, durable construction and modern design
- Enables view through and privacy with minimal light gaps and panel lin options
- Enhance sustainability and efficiency with complete light and thermal c
- Stylish single or multi-channel motor, wall mounted or handheld contr
- phone compatibility
- Leveling control; multiple shades finish in the same position for a premi aesthetic.
- Max width of 120" (based on 120" drop). Capacity to cover areas up to 1 before linking

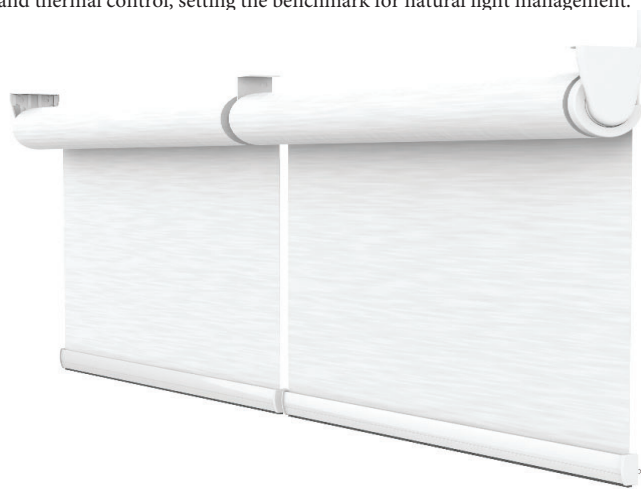

Match this solution with any of our sunscreen, blockout or high performance fabrics for a complete finished solution. See our document library for comprehensive information including HPD, LEED & NRC specifications.

### BRACKET COLORS

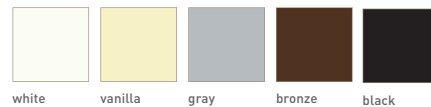

### MOTOR OPTIONS

#### Automate Wall Switches [Hand held or wall mounts]



#### Automate ARC Repeater [Extends the ARC signal]



#### ARC Relay Module [Smart System Interface]



#### Automate Pulse Hub [Smart Phone Control]



FRONT & SIDE VIEW

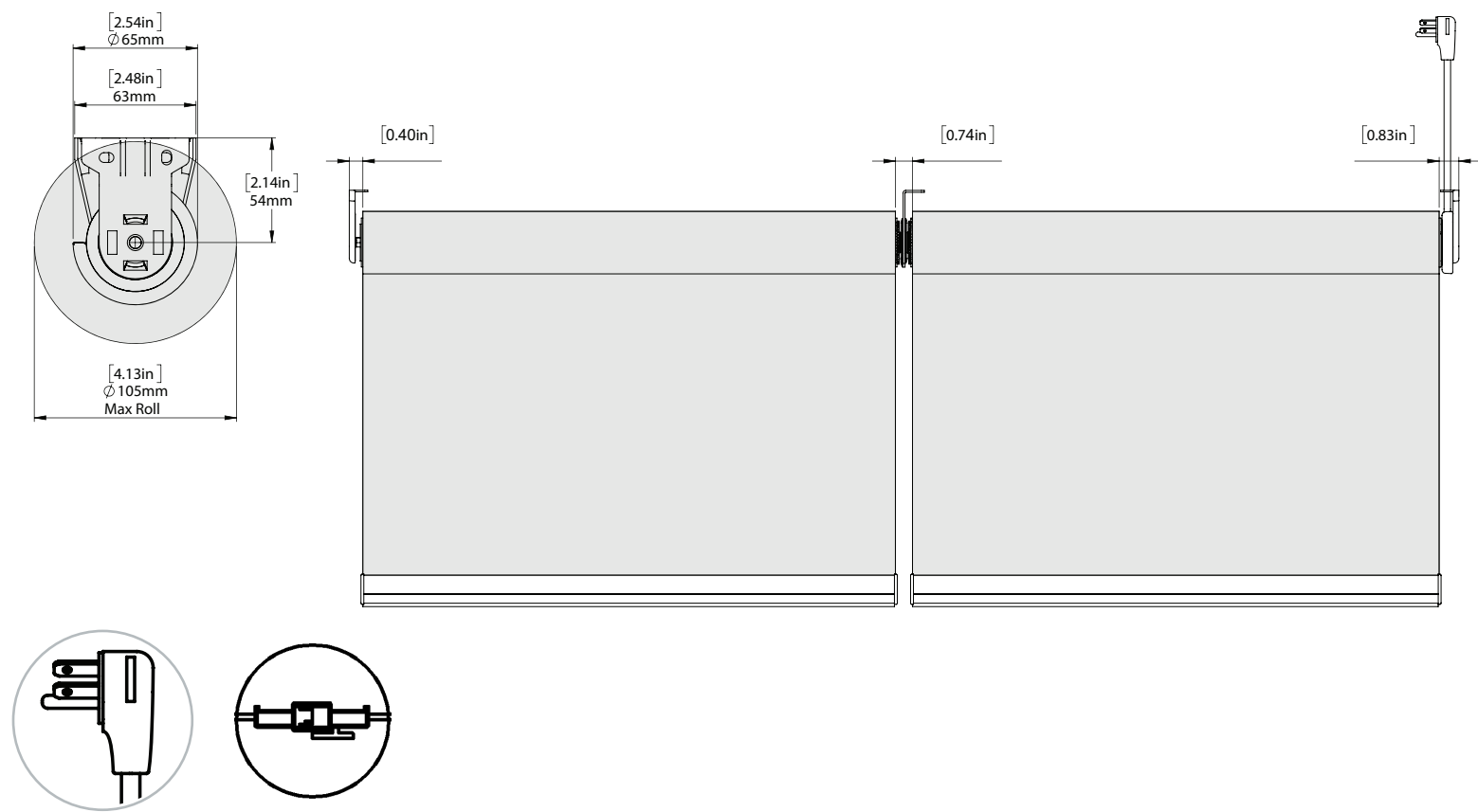

SCHEMATIC

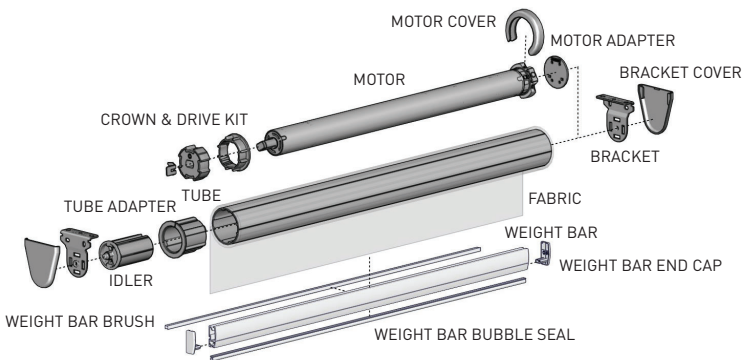

BOTTOM RAIL OPTIONS

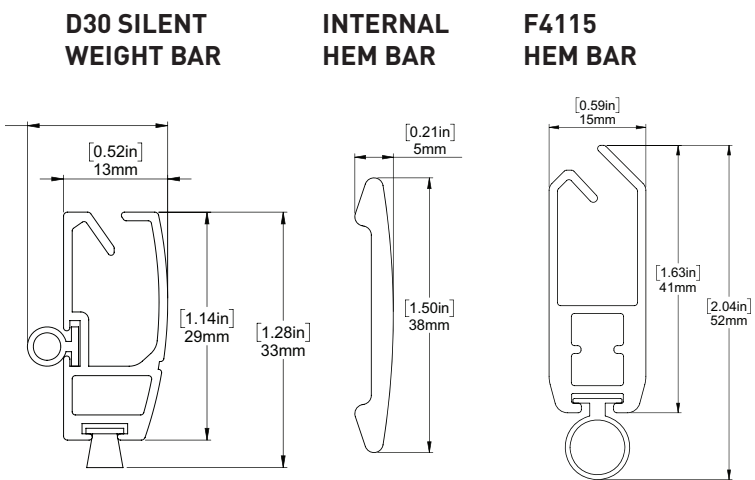

SYSTEM UPGRADES

**5" Pocket**  
[for hidden recess mounts]

**L & I Clips**  
[for hidden recess mounts]

**Edge Side Channels**  
[for improved light blackout]

**Internal Wire Guide**  
[supporting complex shading systems]

**Fabric Switch System**  
[fast easy changing of fabric on a roller shade]

For more information about our Upgrade solutions, see our UPGRADE SPECIFICATION sheets.